

- Break Glass Point (1200mm affl)
- FD 1 hour fire door with intumescent strips & door closers
- FD1 As FD, held open with magnetic catch linked to fire alarm.
- SD Smoke detector
- ☒ Fire Alarm Control Panel
- △ F Foam fire extinguisher, wall mounted 6 litre capacity unless otherwise stated
- △ W Water fire extinguisher, wall mounted 9 litre capacity unless otherwise stated
- △ C Wet Chemical fire extinguisher.
- △ B Fire Blanket

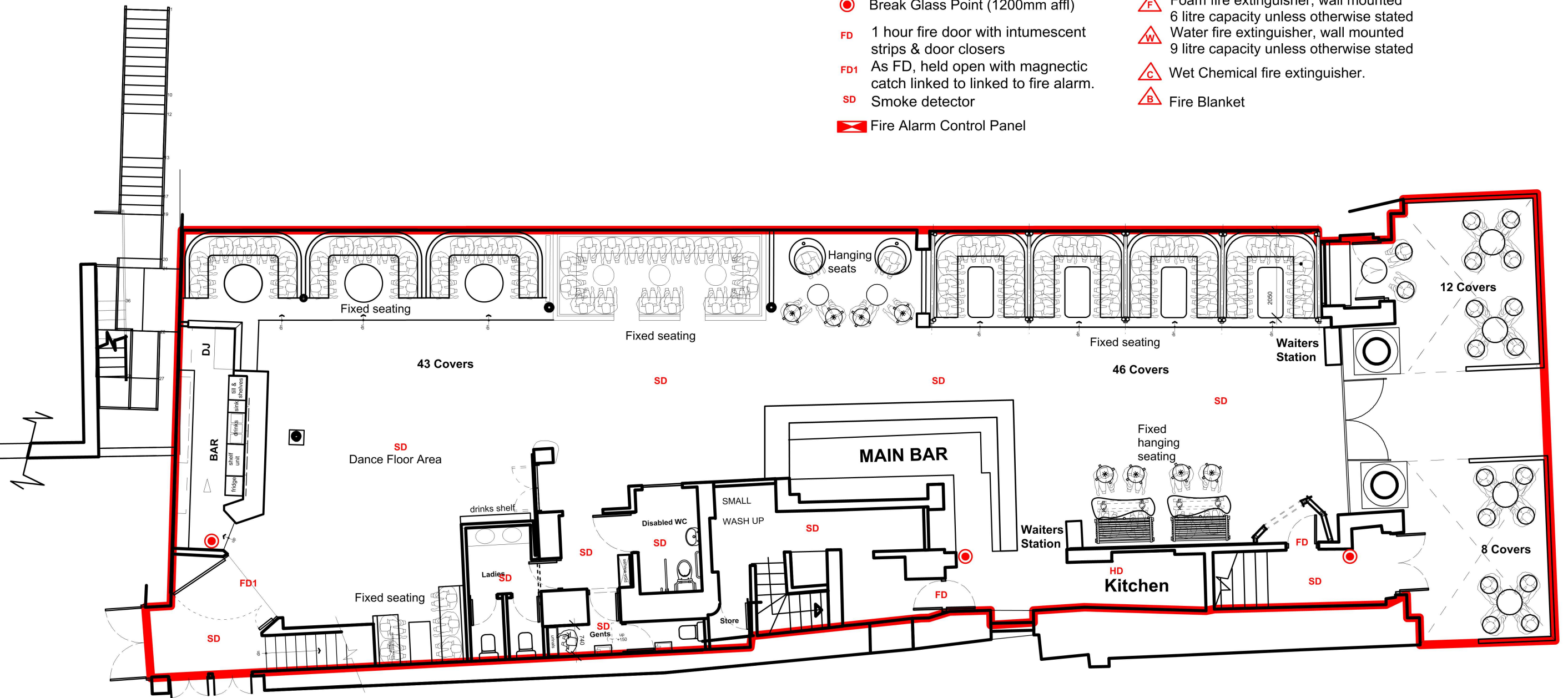

— Extent of Licensed Premises

Notes:

Licensed Activities may take place anywhere within the red line
 Locations of fire safety and other equipment are indicative only and may change following a fire risk assessment or on the advice of the fire officer
 Any detail not required by regulations is indicative only and subject to change without notice

01 **GF Floor Licensing Plan** scale 1:100 @ A3

rev:	date:	description:

client:	Creative HG
project:	Bambu
title:	GF Floor Licensing Plan

scale:	1:100 @ A3	date:	08/06/20
drawing no:	BAM AB 12	rev:	C
drawn by:	SP		

Figured dimensions are to be followed in preference to dimensions scaled from drawings. All dimensions are to be checked on site by contractors and said dimensions are to be their responsibility. Drawing errors and omissions to be reported to the designer.

Contractors to conform to all current Building and Planning Regulations and liaise with relevant Local Authority Departments.

This drawing is copyright of Speake Design. There is no inferred copyright. Copyright is reserved by them. The drawing is issued on condition that it is not copied or disclosed by or any unauthorized persons without prior consent in writing of - Speake Design.